

Power X

High Power Condensing Wall-Hung Boilers



Residential Heating/Light Commercial



Power X: the new high power range by Beretta

Power X is a high power condensing wall-hung boiler, designed for light commercial applications, like villas and multi-dwelling units.

It comes in 4 models that, thanks to a complete range of accessories, can be configured in different ways,

according to your installation and comfort needs:

- **Power X 50 (only heating model);**
- **Power X 35 R.S.I., 50 DEP R.S.I., 50 R.S.I. (only heating models with built-in 3-way valve).**



TECHNOLOGY AND CONTROL

Simple and user-friendly control panel

Power X is featured by a simple and user-friendly digital display that provides the end-user immediately with all information about the boiler status.

The touch buttons allow to easily select all the functions necessary to the use and setting of the boiler.

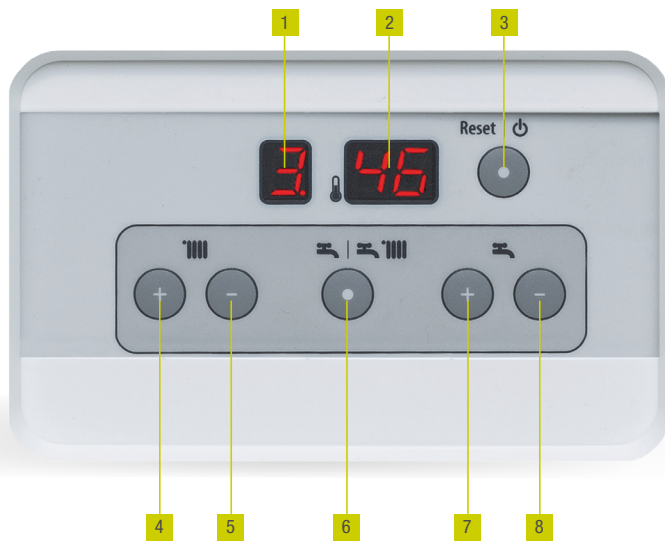

KEY:

- 1 Digital display for information about boiler status
- 2 Digital display for heating/DHW temperature setting
- 3 ON/OFF and reset selector
- 4 Touch button for central heating temperature increase
- 5 Touch button for central heating temperature decrease
- 6 Summer/winter selector
- 7 Touch button for DHW temperature increase
- 8 Touch button for DHW temperature decrease

Saving energy, saving money

The new energy labelling, that according to the ErP directive was implemented in September 2015 for appliances and systems producing heating and domestic hot water, means that all boilers and heating systems are labelled in the same way as “white goods”, like washing machines and refrigerators.

The energy labelling enables the end-users to make realistic comparisons among different products. By choosing high efficiency products, the end-users can lower their energy bills, helping to safeguard the environment.

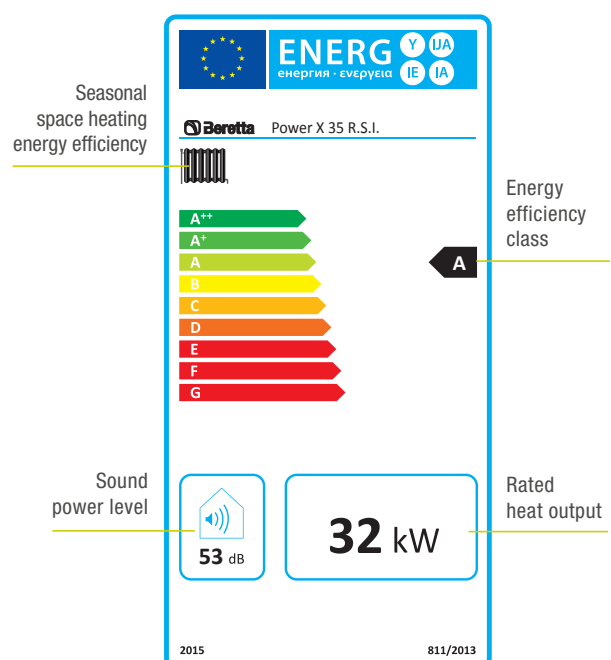

Note: The values in this label refer to POWER X 35 R.S.I. Specifications for each model are detailed at page 9.

TECHNOLOGY AND CONTROL

High condensing technology

The Power X condensing heat exchanger has a high exchange surface and an excellent corrosion resistance. It is made of a continuous corrugated bi-metallic tube (copper alloy on the water side and stainless steel on the flue side), coiled up inside a cylidric structure in stainless steel. This structure is closed on the upper side by a header in die-cast aluminium and on the lower side by a composite plastic header. The counter flow heat transfer is particularly advantageous as the flue temperature is lowered (**5° C more than the return water**). The total pre-mix burner ensures a constant calibrated gas and air mix under any running conditions, translating into highest efficiency.

KEY

- 1 Fan
- 2 Gas valve
- 3 Air inlet
- 4 Flue outlet
- 5 Condensate drain
- 6 Ignition and flame control electrode
- 7 Air/Gas conveyor
- 8 Burner
- 9 Heat exchanger
- 10 Return pipe

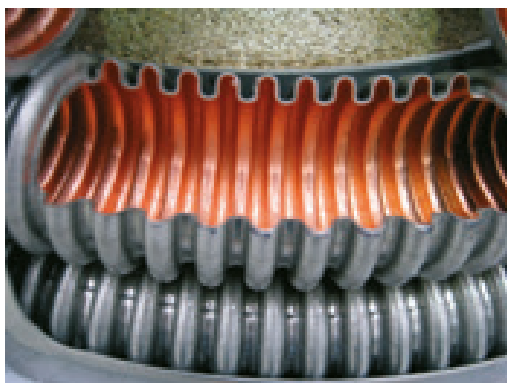
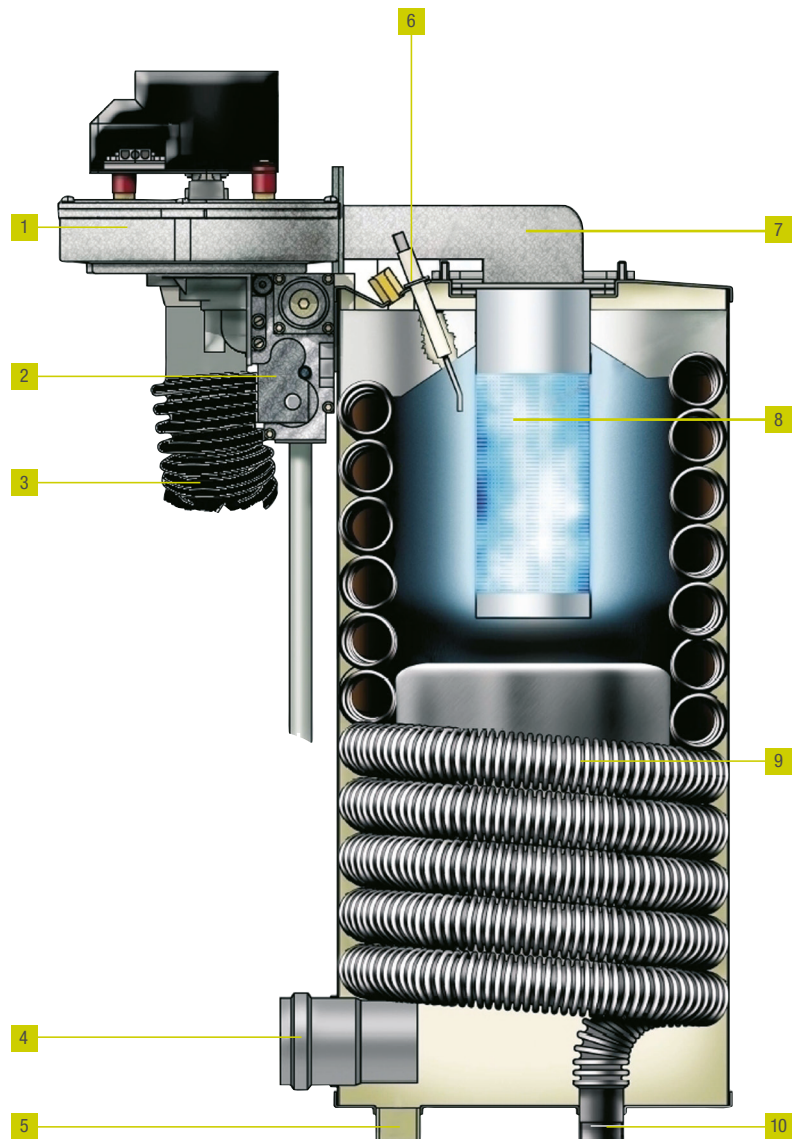

- Heat exchanger made of a coiled corrugated bimetallic pipe.
- Pre-mix burner: Low NOx Class 5 (Directive EN 483)
- Thermoregulation as standard with outdoor probe as option
- Gas Directive EEC 90/396
- Low voltage Directive EEC 89/336
- Electromagnetic compatibility Directive EEC 73/23

Section of bimetallic corrugated pipe

TECHNOLOGY AND ADVANTAGES

New bimetallic (stainless steel - copper) condensing heat exchanger

Modulation ratio up to 6:1

Condensate collector syphon

Low Energy modulating synchronous pump (ErP compliant - $EEL \leq 0,20$), 7m head, with anti-blockage cycles system

Built-in 3-ways valve as standard (on the models 35 R.S.I., 50 DEP R.S.I., 50 R.S.I.)

Electronic board with self-diagnostic function and frost protection

Total pre-mix burner with low emissions: Class 5 (UNI EN 483)

Possibility to directly connect a DHW tank via the built-in 3-ways valve (on R.S.I. models) or via an external 3-ways valve (on 50 model), for the production of DHW

Climatic thermoregulation as standard with outdoor probe (as option)

Flue gas analysis

Built-in 12 lt. expansion vessel (on 35 R.S.I. model)

12 and 18 lt. expansion vessels available as option (for the 50 DEP R.S.I., 50 R.S.I. and 50 models)

Management of three circuits: high temperature, low temperature and DHW tank

ΔT flue/water return: max 5°C



TECHNOLOGY AND EFFICIENCY

Low Energy pump and differential pressure switch

The Power X boiler range is equipped with the new Low Energy modulating pump already connected hydraulically and electrically, providing a high energy saving and a significant reduction in electrical consumption.

The new pump, thanks to the innovative electronic board already inside to the boiler, can work in two modality: as modulating and in a fixed way. The pump in a fixed mode, can work with three speeds:

- low-speed
- normal speed
- maximum speed

The factory setting is for modulating mode: in this case, on

the system request, the pump starts at maximum speed for 1 minute and modulates, up to the achievement of the ΔT required (ΔT is selectable).

The boiler is equipped also with an anti-blocking system, which activates an operating cycle after every 24 hours of disuse, regardless of the mode selector's position.

The flow rate indicated in the graph refer to the range of possible speeds. Power X also features a differential pressure switch, which detects a minimum value of flow rate and system pressure.

Other hydraulic accessories and safety devices are available for Power X range (see the following pages).

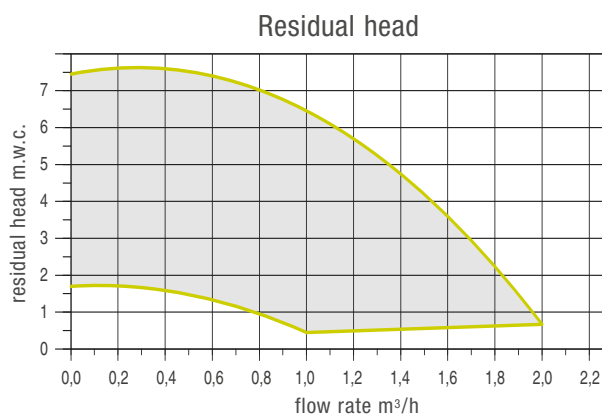

BeSMART WiFi compatible

Power X is compatible with the BeSMART WiFi (as ON/OFF thermostat), the new solution by Beretta to manage your home heating from wherever you are in the world, via the BeSMART App.

From any **smartphone or tablet** you will be able to programme your comfort in an easy and intuitive way, adapting your heating times to your lifestyle

or daily program.

BeSMART WiFi is very easy and quick to install and allows to manage up to 8 heating zones. All main heating program information are displayed on the thermostat or available via App.

For further information visit our website berettaboilers.com or besmart-home.com.

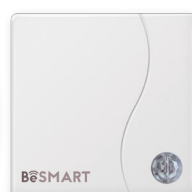
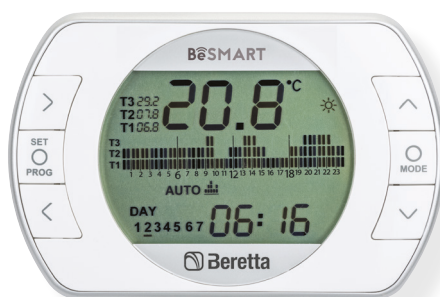

TECHNICAL DRAWINGS

POWER X 35 R.S.I.

POWER X 50 - POWER X 50 R.S.I. - POWER X 50 DEP R.S.I.

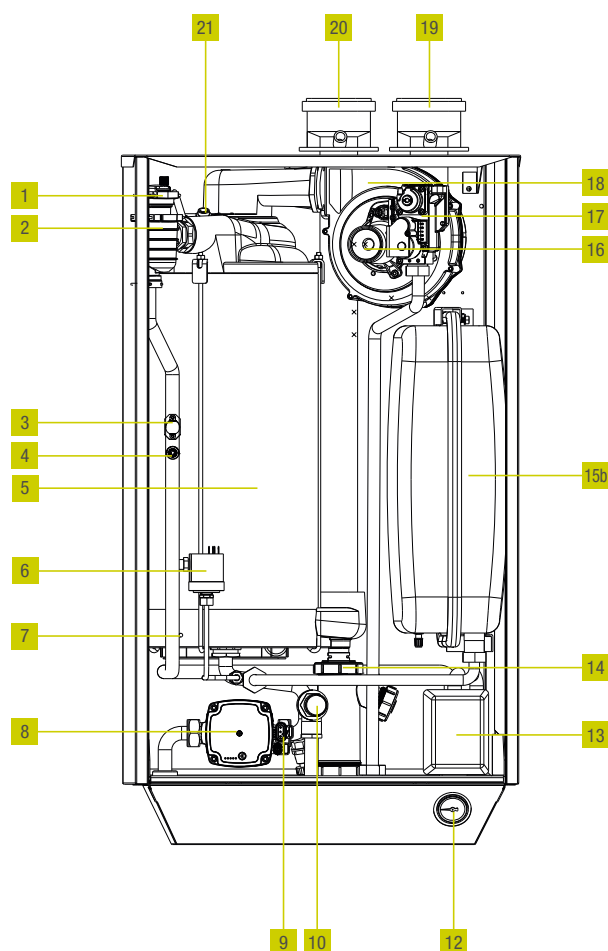
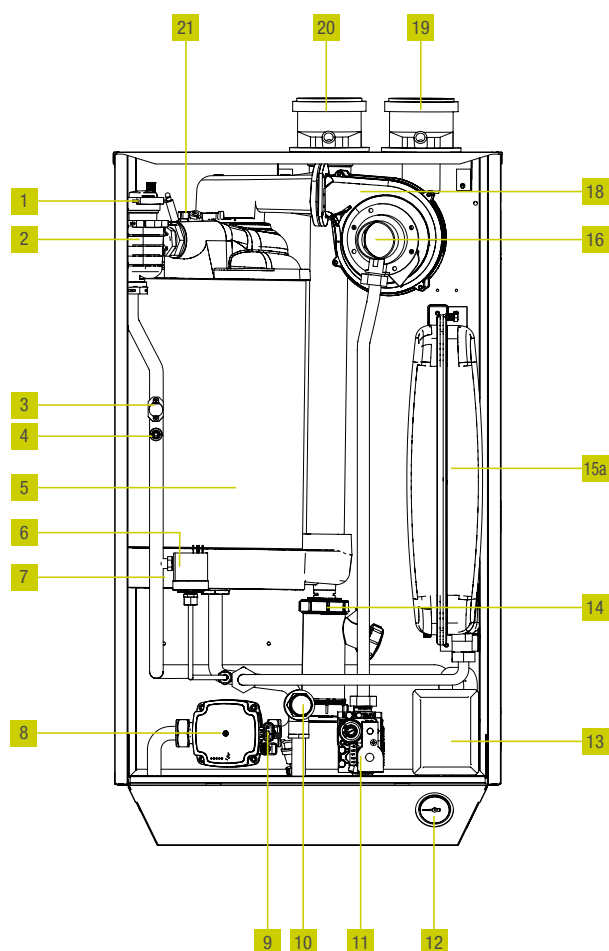

KEY:

- | | | |
|--------------------------------|--|--|
| 1 Automatic air vent valve | 9 Return sensor | 15b 12/18 lt. expansion vessel as option (on the 50 DEP R.S.I., 50 R.S.I. and 50 models) |
| 2 Deaerator | 10 Safety valve (3,5 bar) | 16 Venturi |
| 3 Safety thermostat | 11 Gas valve | 17 Gas valve |
| 4 Flow sensor | 12 Hydrometer | 18 Fan |
| 5 Condensing heat exchanger | 13 Built-in 3-ways valve (*) | 19 Air inlet |
| 6 Differential pressure switch | 14 Syphon condensate drain | 20 Flue |
| 7 Flue temperature probe | 15a 12 lt. built-in primary expansion vessel (only on the 35 R.S.I. model) | 21 Ignition and detection electrode |
| 8 Pump | | |

Note: (*) Built-in on all R.S.I. models. For Power X 50 the 3-ways valve is available as option (cod. 20028476) to be placed outside the boiler.

TECHNICAL DRAWINGS

POWER X 50 / POWER X 50 R.S.I. / POWER X 50 DEP R.S.I. / POWER X 35 R.S.I.

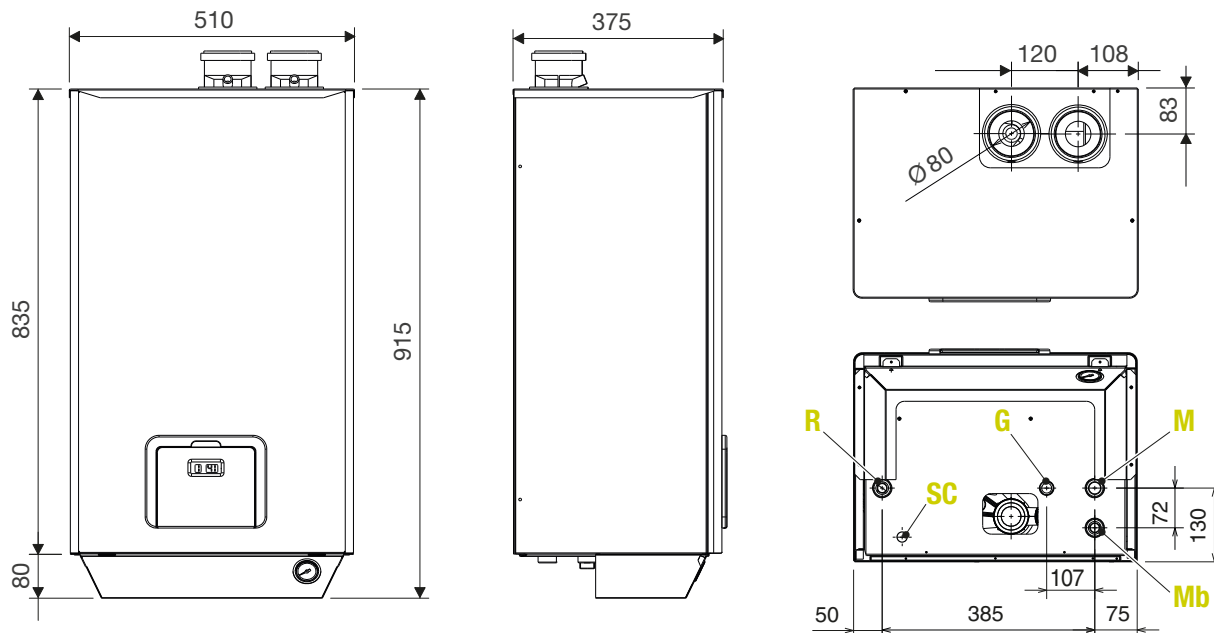

HYDRAULIC CIRCUIT

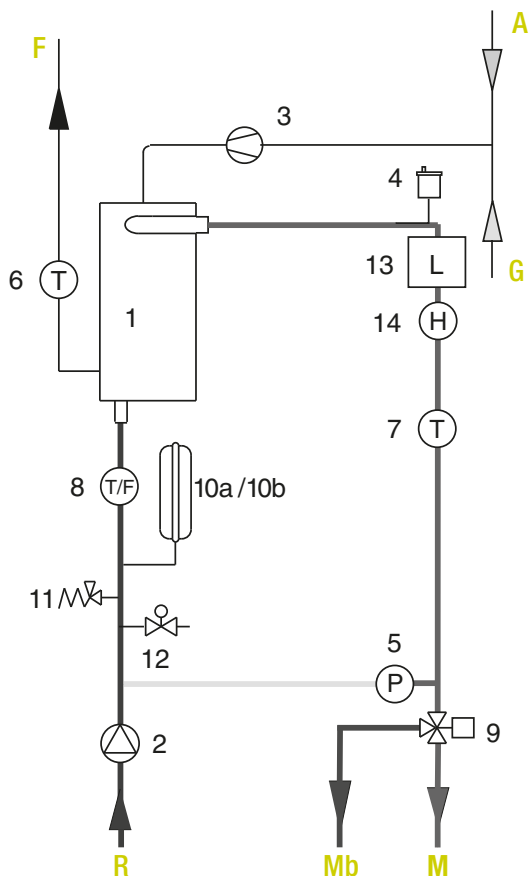

KEY:

- 1 Condensing heat exchanger
- 2 Modulating pump
- 3 Fan
- 4 Automatic air vent valve
- 5 Differential/minimum pressure switch
- 6 Flue temperature probe
- 7 Flow sensor (central heating)
- 8 Return sensor (central heating)
- 9 Built-in 3-ways valve (except for Power X 50)
- 10a 12 lt. expansion vessel as standard on 35 R.S.I. model
- 10b 18 and 12 lt. expansion vessels as option for 50, 50 DEP R.S.I. and 50 R.S.I. models
- 11 Safety valve (3,5 bar)
- 12 Boiler drain
- 13 Deaerator
- 14 Safety thermostat
- A Air
- G Gas (M 3/4" G)
- F Flue
- R Central Heating return* (M 1" G)
- M Central Heating flow (M 1" G)
- Mb DHW tank flow (only on R.S.I. models)
- SC Condensate drain

Note: (*) For the R.S.I. versions it is available the "connection kit for DHW tank return" (code 20123886).

TECHNICAL DATA

FEATURES and MODELS		POWER X 35 R.S.I.	POWER X 50 DEP R.S.I.	POWER X 50 R.S.I.	POWER X 50
Product order code		20124217	20117322	20114815	20114814
Boiler function		heating only with built-in 3 ways valve (*)			heating only



ENERGY LABELLING SPECIFICATIONS (according to ERP regulation)

Seasonal space heating energy efficiency class		A	A	A	A
Seasonal space heating energy efficiency	%	92,8	92,4	92,5	92,5
Sound power level inside	dB	53	58,2	58,2	58,2

SPECIFICATIONS

Heat input ref. Hs (HHV) min-max	kW	5,8 - 35,0	15,0 - 38,6	15,0 - 50,0	15,0 - 50,0
Heat input ref. Hi (NHV) min-max	kW	5,2 - 31,5	13,5 - 34,8	13,5 - 45,0	13,5 - 45,0
Useful heat output ref. Hi (NHV) (80 - 60 °C)	kW	30,90	34,37	44,20	44,20
Useful heat output ref. Hi (NHV) (50 - 30 °C)	kW	34,00	37,70	48,50	48,50
Quantity of condensate (50 - 30 °C) NG	l/h	4,8	5,1	6,6	6,6
Useful efficiency ref. Hi (NHV) (80 - 60 °C)	%	98,00	98,20	98,20	98,20
Useful efficiency ref. Hi (NHV) (50 - 30 °C)	%	108,13	107,70	107,70	107,70
Useful efficiency at ref. Hi (NHV) 30% (80 - 60 °C)	%	97,99	98,70	98,70	98,70
Useful efficiency at ref. Hi (NHV) 30% (50 - 30 °C)	%	109,20	108,70	108,70	108,70
Losses via the chimney with the burner operating (80 - 60 °C)/(50 - 30 °C)	%	1,3/0,61	1,3/0,9	1,3/0,9	1,3/0,9
Losses via the chimney with the burner off	%	0,1	0,1	0,1	0,1
Losses via the casing with the burner operating	%	0,2	0,5	0,5	0,5
Flue gas temperature	°C	Return temperature + max 5°C			
NOx	Class	5	5	5	5

CENTRAL HEATING

Maximum operating pressure	bar	3,5	3,5	3,5	3,5
Range of boiler water temperature settings (min/max)	°C	10/80	10/80	10/80	10/80
Hydraulic residual head at 1000l/h	bar	0,6	0,6	0,6	0,6

ELECTRICAL SPECIFICATIONS

Power supply	V/Hz	230/50	230/50	230/50	230/50
Index of electrical protection	IP	X4D	X4D	X4D	X4D
Fan power consumption	W	80	85	100	100
Pump power consumption	W	60	60	60	60

HYDRAULIC AND GAS CONNECTIONS

CH flow	Ø	1"	1"	1"	1"
Gas inlet	Ø	3/4"	3/4"	3/4"	3/4"
CH return	Ø	1"	1"	1"	1"

TWIN FLUE PIPES AND AIR INTAKE Ø80

Max length	m	25 + 25	25 + 25	25 + 25	25 + 25
Loss due to the insertion of a bend 90°/45°	m	3/1	3/1	3/1	3/1

DIMENSIONS AND WEIGHT

Boiler dimensions (H x L x P)	mm	915 x 510 x 375	915 x 510 x 375	915 x 510 x 375	915 x 510 x 375
Dry weight	kg	50	55	55	55
Available gas versions		NG/LPG (**)	NG/LPG (**)	NG/LPG (**)	NG/LPG (**)

(*) The 3-ways valve allows the DHW production via connection with a DHW tank.

(**) LPG version available through LPG transformation kit (supplied as standard)

KEY:

R heating only model

S room-sealed

I electronic ignition + ionisation flame control

ACCESSORIES

Accessories and complementary items

Power X can be installed in different configurations, according to your installation needs. Beretta offers

a complete range of accessories, designed to be perfectly combined with Power X range.

REF.	CODE	DESCRIPTION
HYDRAULIC/ELECTRICAL COMPONENTS and SAFETY DEVICES		
3	20028472	Taps for system
4	20028473	Hydraulic manifold for safety kit
5	20028474	Safety kit (*)
6	20043895	Gas safety cut-off valve 200kW
7	20028475	Hydraulic header separator for single application
8	20028476	3-way valve kit for DHW tank for single application
9	20123886	Connection kit for DHW tank return (for RSI versions)
10	20119840	18 lt expansion vessel kit

REF.	CODE	DESCRIPTION
11	20119841	12 lt expansion vessel kit
12	20125113	External probe kit
13	1103059	Well probe for DHW tank and for Low Temp. zone
14	1220639	Limit thermostat for low temperature applications
29	20128368	Motorized mixing valve kit

SUPPORTS FOR INSTALLATION

15	20046101	Power X rig (front mounting)
16	20047606	Rear mounting kit for free-standing application
17	20120468 *	Rear spacer frame kit for wall-hung application (in case of concentric flue systems)

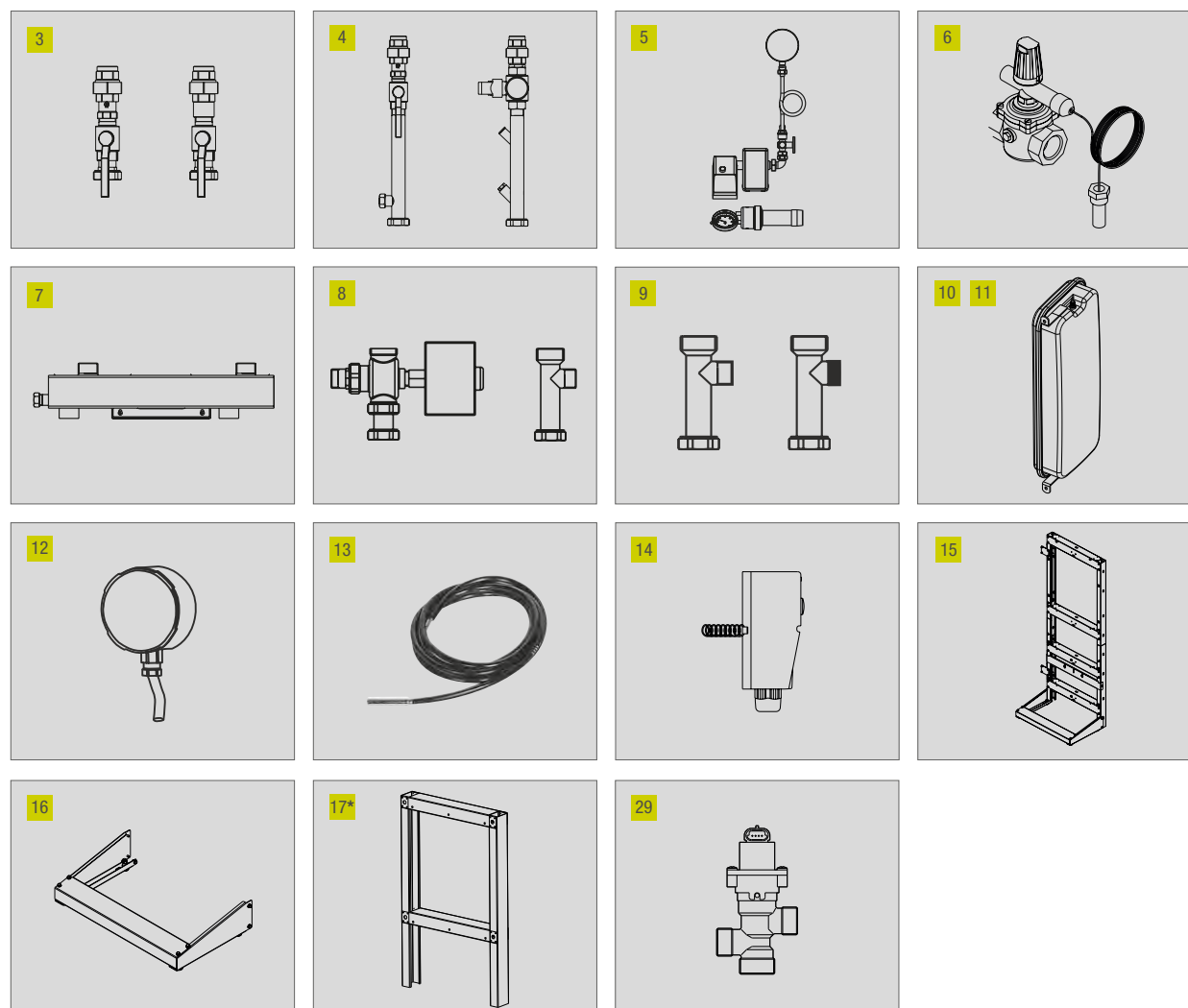

* In case of use of the concentric flue ranges Ø60/100 or Ø80/125, with flue exit from the back side wall of the boiler, via a 90° bend, it is necessary to purchase the rear spacer frame kit, code 20120468 (75,5 mm depth).

Note: (*) According to I.N.A.I.L. Italian Safety Certification Institute (mandatory only on the Italian market), the kit is composed by: INAIL type-approved safety thermostat with manual reset [100(0-6°C)]; INAIL type-approved thermometer (0-120°C); thermometer well/duct; INAIL type-approved safety valve (3,5 bar); INAIL type-approved safety pressure switch with manual reset; INAIL type-approved manometer-holder 3-ways tap; damper coil; INAIL type-approved manometer (0-6 bar); brass fitting connection.

ACCESSORIES - FLUES

Flue adapters

REF.	CODE	DESCRIPTION
FLUES / AIR INTAKE		
18	20028478	Air-intake kit B23

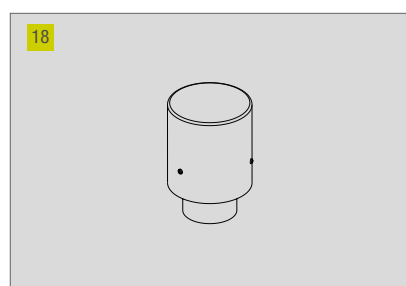

REF.	CODE	DESCRIPTION
19	20028027	Flue adapter kit from Ø80-80 to Ø60/100
20	20028029	Flue adapter kit from Ø80-80 to Ø80/125

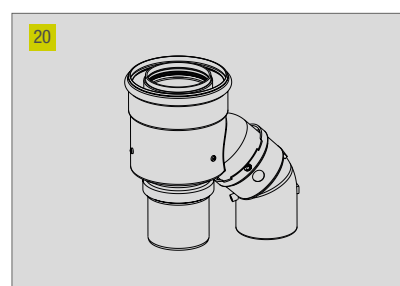
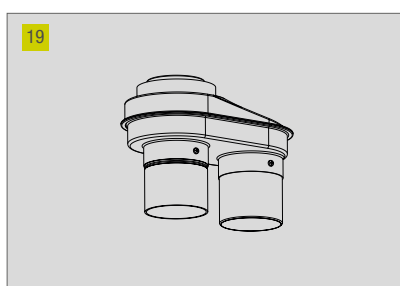

Ø80 twin flue system in plastic (PP)

CODE	DESCRIPTION
20027266	45° bend, Ø80
20027262	90° bend, Ø80
20027219	500 mm extension, Ø80
20027222	1000 mm extension, Ø80

CODE	DESCRIPTION
20027226	2000 mm extension, Ø80
20027272	Horizontal terminal extension L=985 mm, Ø80
20027276	Air inlet horizontal terminal L=660 mm, Ø80
1220199	Spacers for pipe, Ø80 (4 pcs.)

Ø60/100 concentric flue system* in plastic (PP/PPu)

CODE	DESCRIPTION
20027192	45° concentric bend, Ø60-100
20027201	90° concentric bend, Ø60-100
20027161	500 mm concentric extension, Ø60-100
20027166	1000 mm concentric extension, Ø60-100

CODE	DESCRIPTION
20027179	2000 mm concentric extension, Ø60-100
20027212	Vertical extension, Ø60-100 - external straight pipe Ø125
20027555	Horizontal terminal extension, Ø60-100
1100129	Spacers for pipe, Ø100 (4 pcs.)

Ø80/125 concentric flue system* in plastic/Aluminium (PP/Al)

CODE	DESCRIPTION
1101599	45° concentric bend, Ø80-125
1101609	90° concentric bend, Ø80-125
1101649	90° concentric bend with inspection, Ø80-125
1101619	500 mm concentric extension, Ø80-125
1101629	1000 mm concentric extension, Ø80-125

CODE	DESCRIPTION
1101639	2000 mm concentric extension, Ø80-125
1101659	Concentric extension with inspection, Ø80-125
1101669	Vertical extension, Ø80-125 - external straight pipe Ø125
1101679	Horizontal extension, Ø80-125
20062440	Spacers for pipe, Ø80-125 (5 pcs.)

* In case of use of the concentric flue ranges Ø60/100 or Ø80/125, with flue exit from the back side wall of the boiler, via a 90° bend, it is necessary to purchase the rear spacer frame kit, code 20120468 (75,5 mm depth).

Note: Due to exposition to sunlight, the colour of the material (PP) may be altered.

DHW TANK

Idra BV

Idra BV is the ideal DHW tank range to be matched with Power X. It comes in 6 different sizes that can cover all your installation and comfort needs. The two

installation schemes in the following page illustrate how Power X can manage a mixed system:
1 High Temperature + 1 Low Temperature and a DHW tank.

CODE	DESCRIPTION	DIMENSIONS HxØ (mm)	CYLINDER CAPACITY (litres)	HEAT LOSS (W)	ENERGY CLASS	A (mm)	B (mm)	C (mm)	D (mm)	E (mm)
20101895	IDRA BV 200	1330x605	210	59	B	170	315	565	745	1170
20101897	IDRA BV 300	1830x605	304	69	B	170	315	805	965	1670
20101899	IDRA BV 430	1630x755	444	83	C	205	405	780	1005	1440
20101900	IDRA BV 550	1980x755	556	96	-	205	405	780	1005	1785
20101901	IDRA BV 800	1835x1000	735	135,5	-	75	355	825	1125	1705
20101902	IDRA BV 1000	2165x1000	890	142,5	-	75	355	910	1125	2030

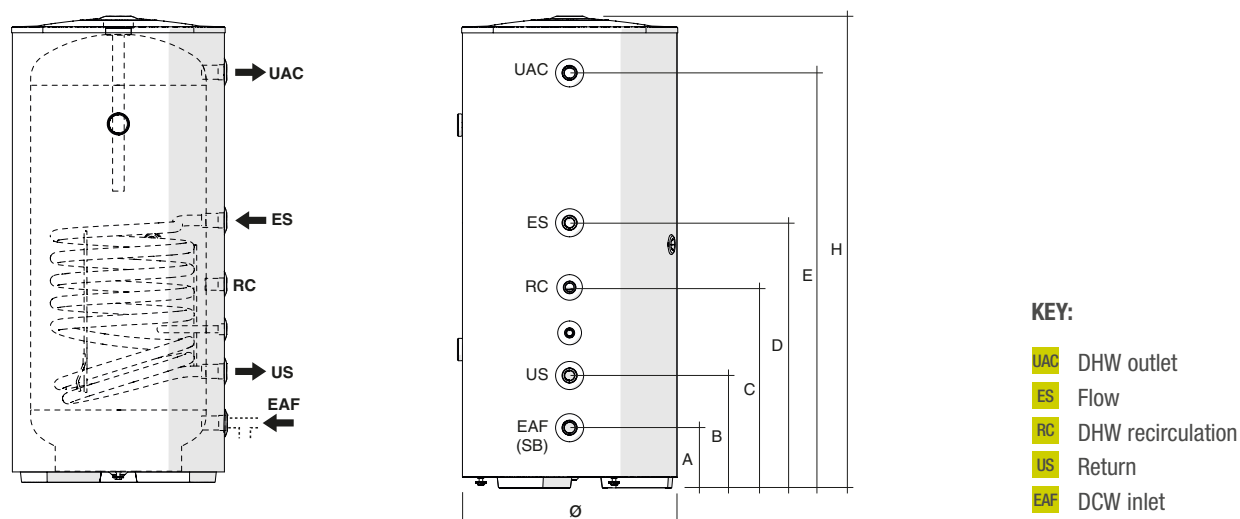

ACCESSORIES

REF.	CODE	DESCRIPTION
21	20055206	1/2" electronic anode kit *
22	1150529	Thermostatic mixing valve 3/4"
23	20001492	Thermostatic mixing valve 1" with 3/4" adapter

REF.	CODE	DESCRIPTION
24	1150489	18 lt expansion vessel
25	1150509	24 lt expansion vessel
26	1150519	35 lt expansion vessel

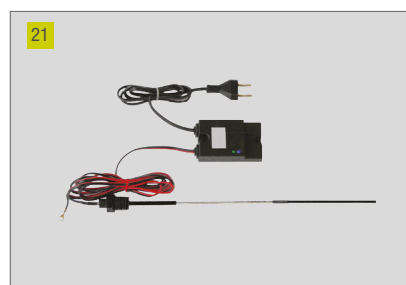

Note: (*) For the coupling with the electronic anode kit a reduction to 1/2" is needed (not included in the kit)

SYSTEM DIAGRAM

Management of a mixed system: 1 High Temperature + 1 Low Temperature and a DHW tank

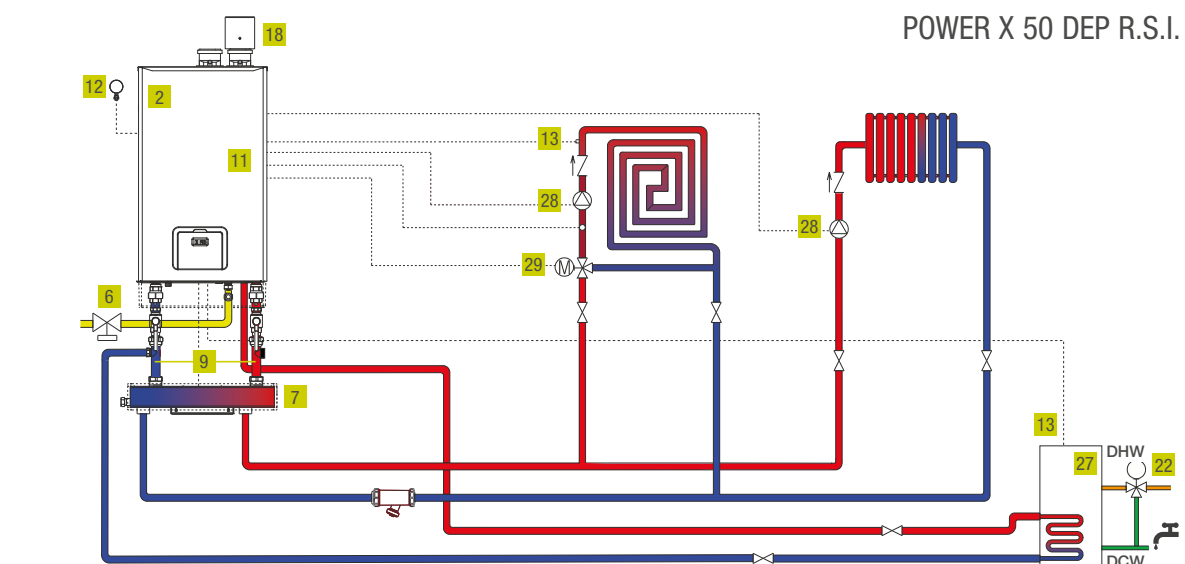
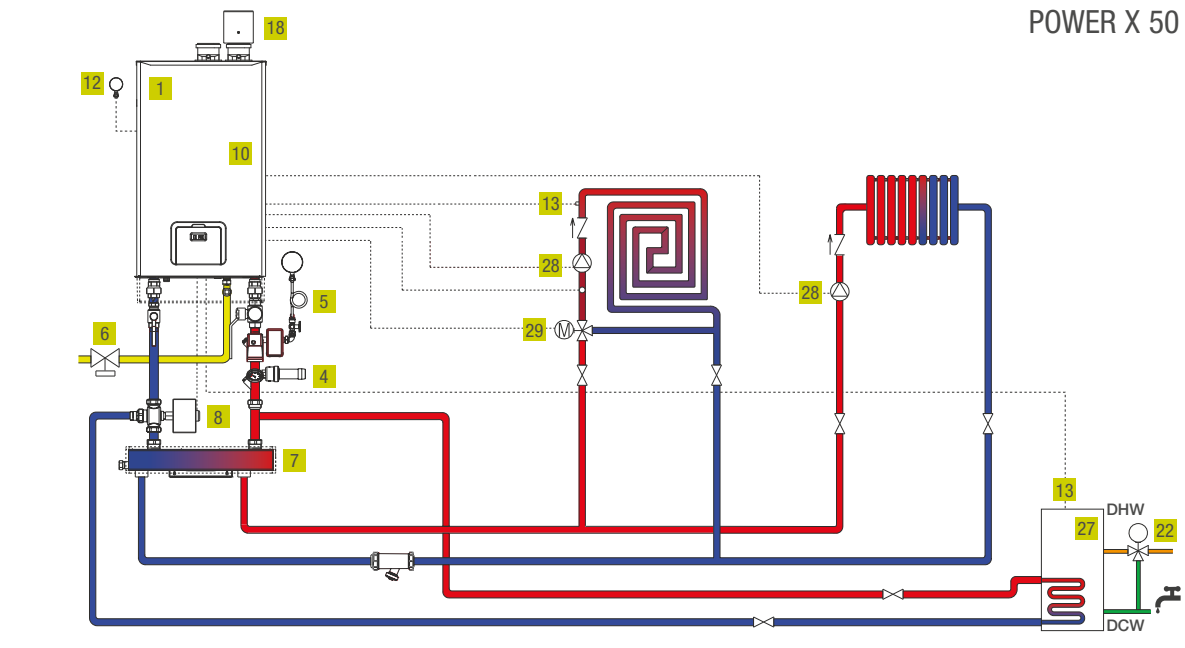

KEY:

- | | | | | | |
|----------|--|-----------|---|-----------|---|
| 1 | Power X 50 (20117814) | 8 | 3-way valve kit for DHW tank (20028476) | 12 | External probe kit (20125113) |
| 2 | Power X 50 DEP R.S.I. (20117322) | 9 | Connection kit for DHW tank return (20123886) | 13 | Well probe (1103059) |
| 4 | Hydraulic manifold for safety kit (20028473) | 10 | 18 ft. expansion vessel (optional kit 20119840) | 18 | Air-intake kit B23 (20028478) |
| 5 | Safety kit (20028474) | 11 | 12 ft. expansion vessel (optional kit 20119841) | 22 | Thermostatic mixing valve (1150529 or 20001492) |
| 6 | Gas safety cut-off valve 200kW (20043895) | | | 27 | DHW tank IDRA BV |
| 7 | Hydraulic header separator (20028475) | | | 28 | Pump ^(a) |
| | | | | 29 | Motorized mixing valve (20128368)* |

Note: (a) Not available in the Beretta International Product Catalogue:

* Mixing valve with a 24Vac stepper motor and 4 wires, to be connected on the boiler control board to the terminals dedicated to the Low Temp. zone.

These schemes have only an indication purpose

WALL-HUNG APPLICATIONS

POWER X 50 DEP R.S.I. / POWER X 50 R.S.I.

CONFIGURATION FOR CENTRAL HEATING AND DHW TANK

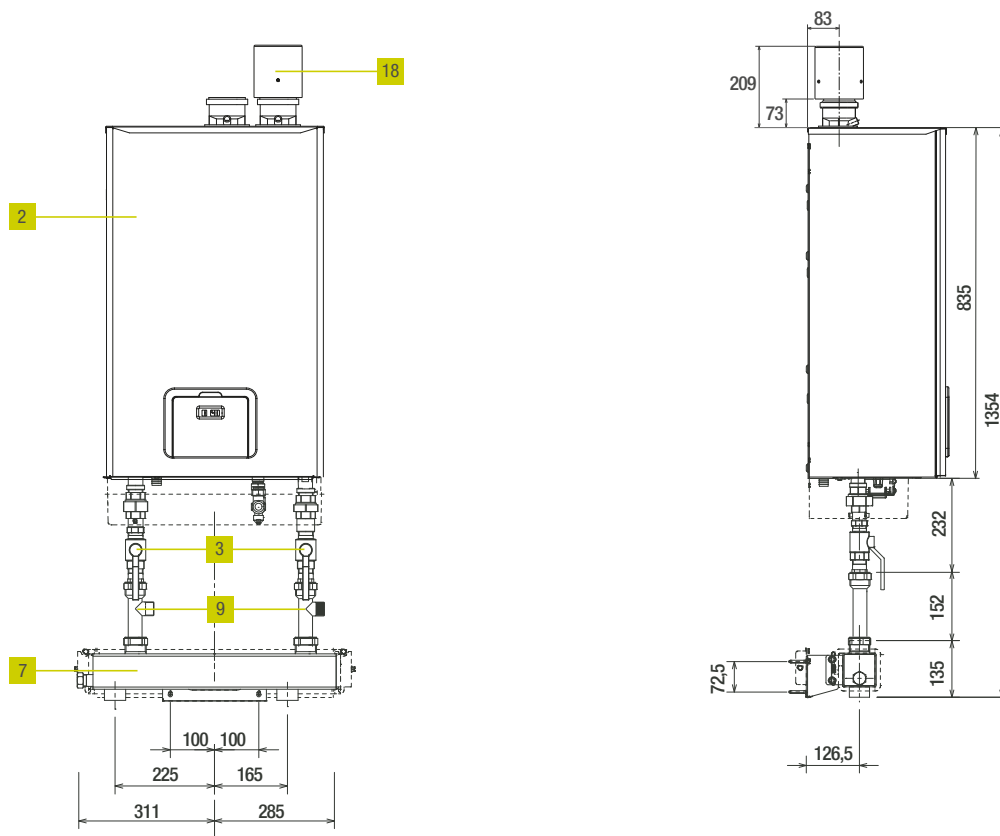

DIAGRAM REF.	CODE	DESCRIPTION	Q.TY
BOILERS			
2	20117322	Power X 50 DEP R.S.I. (A)	1
HYDRAULIC COMPONENTS and SAFETY DEVICES			
3	20028472	Taps for system	1
7	20028475	Hydraulic header separator for single applic.	1

DIAGRAM REF.	CODE	DESCRIPTION	Q.TY
9	20123886	Connection kit for DHW tank return	1
FLUES / AIR INTAKE			
18	20028478	Air-intake kit B23 (B)	1
ACCESSORIES FOR DHW TANK (C)			
-	1103059	Well probe for DHW tank	1

(A) The configuration illustrated in this page can be applied also with POWER X 50 R.S.I. (code 20114815).

Inside the Power X boilers range (except for Power X 35 R.S.I.), it is possible to insert, in the proper compartment, the optional expansion vessel kit of 18 lt. (code 20119840), or the optional expansion vessel kit of 12 lt. (code 20119841).

(B) The Power X configurations can be completed with the flue options Ø80 mm of the section FLUES for CONDENSING BOILERS of the International Product Catalogue. As an alternative, you can use the concentric flue options Ø60/100 mm (by purchasing the flue adapter kit from Ø80-80 to Ø60/100, code 20028027) or the concentric flue options Ø80/125 mm (by purchasing the flue adapter kit from Ø80-80 to Ø80/125 code 20028029). In both cases, the accessory air-intake kit B23, code 20028478, is not necessary. **In case of use of the concentric flue ranges Ø60/100 or Ø80/125, with flue exit from the back side wall of the boiler, via a 90° bend, it is necessary to purchase the rear spacer frame kit, code 20120468 (75,5 mm depth).**

(C) Inside the R.S.I. models of Power X range, the 3-way valve for DHW tank management is already built-in (like in this configuration).

WALL-HUNG APPLICATIONS

POWER X 50

CONFIGURATION FOR CENTRAL HEATING ONLY

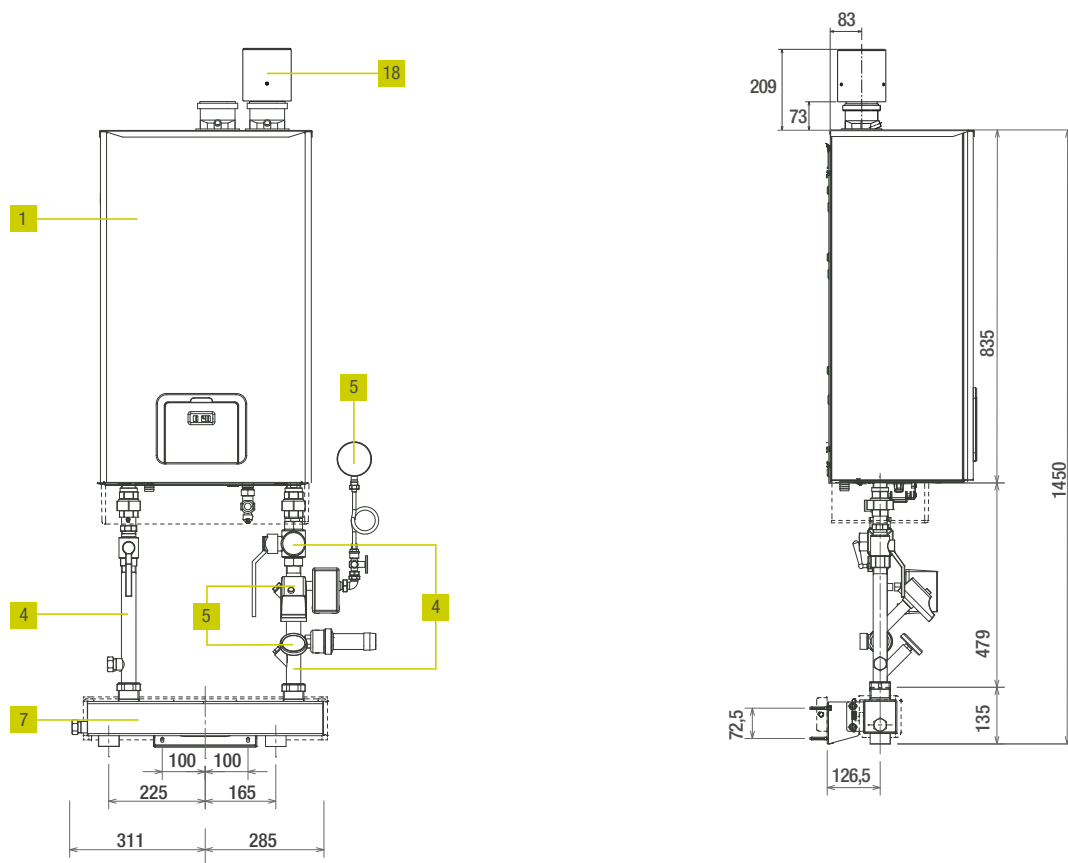

DIAGRAM REF.	CODE	DESCRIPTION	Q.TY
BOILERS			
1	20114814	Power X 50 (A)	1
HYDRAULIC COMPONENTS and SAFETY DEVICES			
4	20028473	Hydraulic manifold for safety kit (B)	1
5	20028474	Safety kit (B)	1

DIAGRAM REF.	CODE	DESCRIPTION	Q.TY
-	20043895	Gas safety cut-off valve 200kW (B)	1
7	20028475	Hydraulic header separator for single applic.	1
FLUES / AIR INTAKE			
18	20028478	Air-intake kit B23 (C)	1

(A) Inside the Power X 50, it is possible to insert, in the proper compartment, the optional expansion vessel kit of 18 lt. (code 20119840) or the optional expansion vessel kit of 12 lt. (code 20119841).

(B) Optional safety component, according to I.N.A.I.L. Italian Safety Certification Institute (mandatory only on the Italian market).

(C) The Power X configurations can be completed with the flue options Ø80 mm of the section FLUES for CONDENSING BOILERS of the International Product Catalogue. As an alternative, you can use the concentric flue options Ø60/100 mm (by purchasing the flue adapter kit from Ø80-80 to Ø60/100, code 20028027) or the concentric flue options Ø80/125 mm (by purchasing the flue adapter kit from Ø80-80 to Ø80/125 code 20028029). In both cases, the accessory air-intake kit B23, code 20028478, is not necessary. **In case of use of the concentric flue ranges Ø60/100 or Ø80/125, with flue exit from the back side wall of the boiler, via a 90° bend, it is necessary to purchase the rear spacer frame kit, code 20120468 (75,5 mm depth).**

WALL-HUNG APPLICATIONS

POWER X 50

CONFIGURATION FOR CENTRAL HEATING AND DHW TANK (WITH EXTERNAL 3-WAYS VALVE)

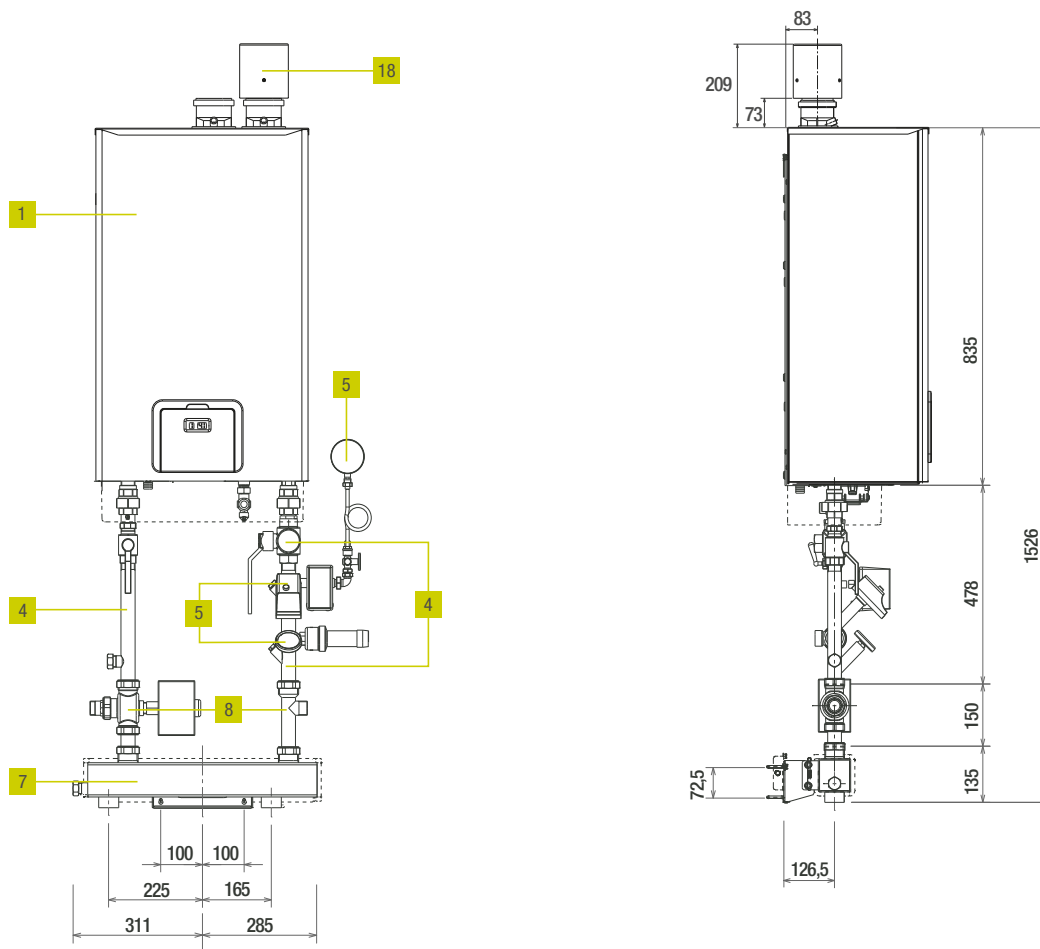

DIAGRAM REF.	CODE	DESCRIPTION	Q.TY
BOILERS			
1	20114814	Power X 50 (A)	1
HYDRAULIC COMPONENTS and SAFETY DEVICES			
4	20028473	Hydraulic manifold for safety kit (B)	1
5	20028474	Safety kit (B)	1
-	20043895	Gas safety cut-off valve 200kW (B)	1

DIAGRAM REF.	CODE	DESCRIPTION	Q.TY
7	20028475	Hydraulic header separator for single applic.	1
FLUES / AIR INTAKE			
18	20028478	Air-intake kit B23 (C)	1
ACCESSORIES FOR DHW TANK			
8	20028476	3-way valve kit for DHW tank	1
-	1103059	Well probe for DHW tank	1

(A) Inside the Power X 50, it is possible to insert, in the proper compartment, the optional expansion vessel kit of 18 lt. (code 20119840) or the optional expansion vessel kit of 12 lt. (code 20119841).

(B) Optional safety component, according to I.N.A.I.L. Italian Safety Certification Institute (mandatory only on the Italian market).

(C) The Power X configurations can be completed with the flue options Ø80 mm of the section FLUES for CONDENSING BOILERS of the International Product Catalogue. As an alternative, you can use the concentric flue options Ø60/100 mm (by purchasing the flue adapter kit from Ø80-80 to Ø60/100, code 20028027) or the concentric flue options Ø80/125 mm (by purchasing the flue adapter kit from Ø80-80 to Ø80/125 code 20028029). In both cases, the accessory air-intake kit B23, code 20028478, is not necessary. **In case of use of the concentric flue ranges Ø60/100 or Ø80/125, with flue exit from the back side wall of the boiler, via a 90° bend, it is necessary to purchase the rear spacer frame kit, code 20120468 (75,5 mm depth).**

FREE-STANDING APPLICATIONS

POWER X 50 DEP R.S.I. / POWER X 50 R.S.I.

CONFIGURATION FOR CENTRAL HEATING AND DHW TANK

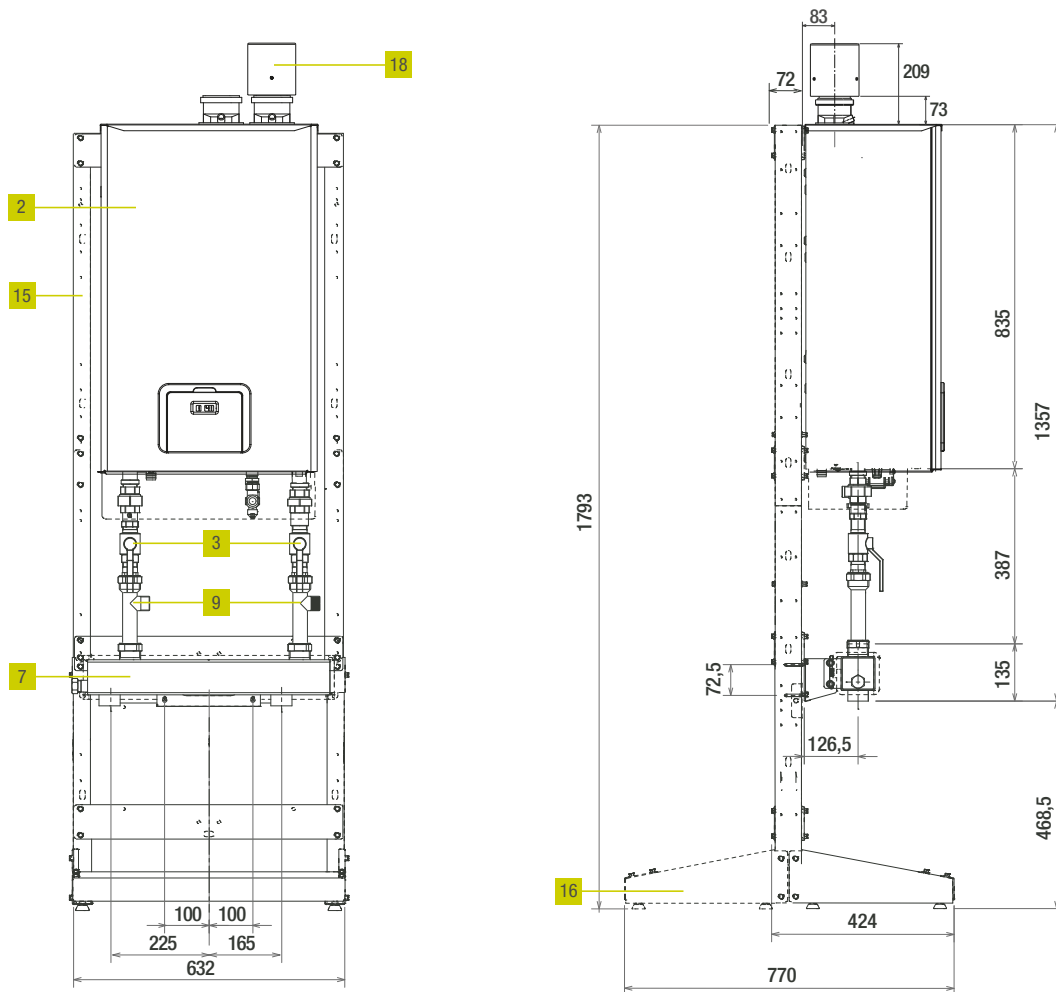

DIAGRAM REF.	CODE	DESCRIPTION	Q.TY
BOILERS			
2	20117322	Power X 50 DEP R.S.I. (A)	1
HYDRAULIC COMPONENTS and SAFETY DEVICES			
3	20028472	Taps for system	1
7	20028475	Hydraulic header separator for single applic.	1
9	20123886	Connection kit for DHW tank return	1

DIAGRAM REF.	CODE	DESCRIPTION	Q.TY
FLUES / AIR INTAKE			
18	20028478	Air-intake kit B23 (B)	1
ACCESSORIES FOR DHW TANK (C)			
-	1103059	Well probe for DHW tank	1
SUPPORTS FOR FREE-STANDING APPLICATION			
15	20046101	Power X rig	1
16	20047606	Rear mounting kit for free-standing applic. (D)	1

- (A) The configuration illustrated in this page can be applied also with POWER X 50 R.S.I. (code 20114815).
Inside the Power X boilers range (except for Power X 35 R.S.I.), it is possible to insert, in the proper compartment, the optional expansion vessel kit of 18 lt. (code 20119840), or the optional expansion vessel kit of 12 lt. (code 20119841).
- (B) The Power X configurations can be completed with the flue options Ø80 mm of the section FLUES for CONDENSING BOILERS of the International Product Catalogue. As an alternative, you can use the concentric flue options Ø60/100 mm (by purchasing the flue adapter kit from Ø80-80 to Ø60/100, code 20028027) or the concentric flue options Ø80/125 mm (by purchasing the flue adaptor kit from Ø80-80 to Ø80/125 code 20028029). In both cases, the accessory air-intake kit B23, code 20028478, is not necessary.
- (C) Inside the R.S.I. models of Power X range, the 3-ways valve for DHW tank management is already built-in (like in this configuration).
- (D) In case you don't need a free-standing application and you wish to anchor the Power X rig to the wall, you don't need to purchase the rear mounting kit, code 20047606 (ref. 16).

FREE-STANDING APPLICATIONS

POWER X 50

CONFIGURATION FOR CENTRAL HEATING ONLY

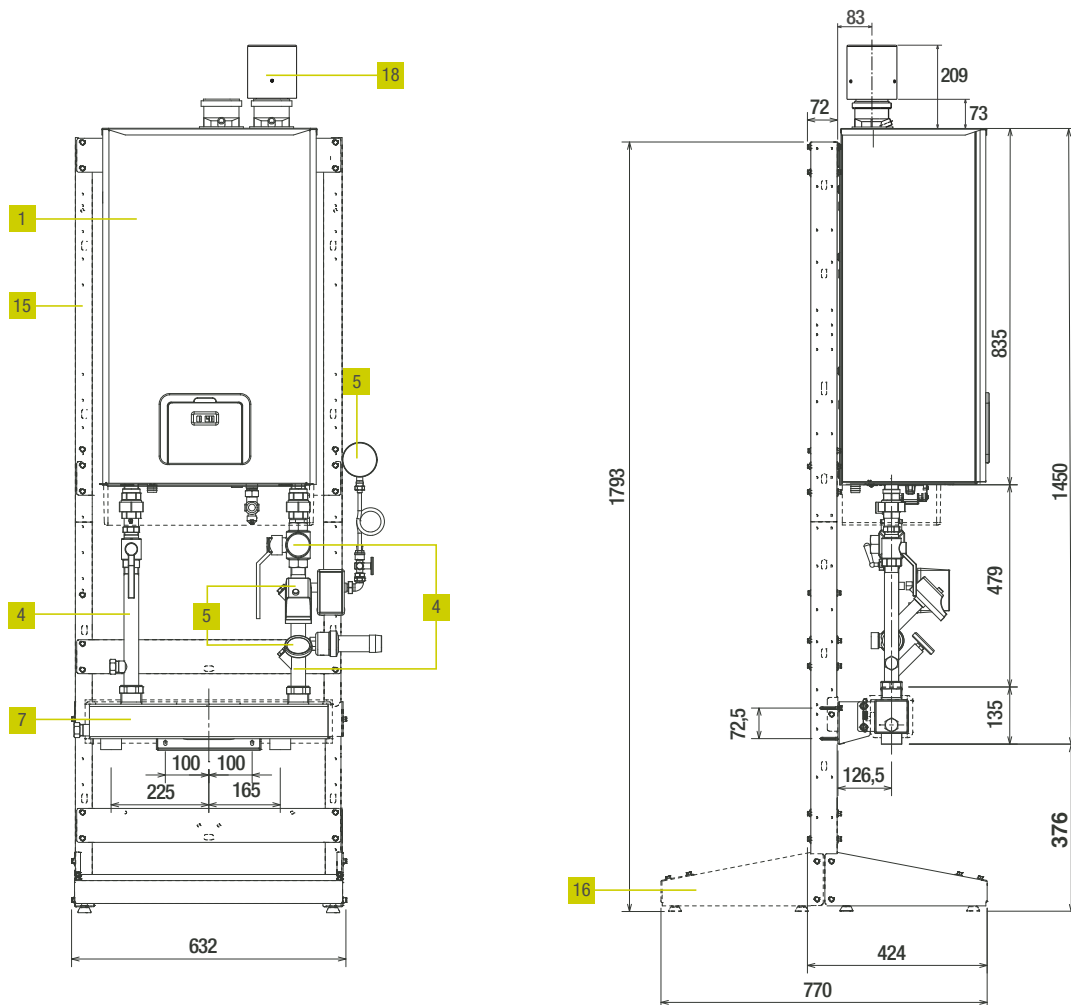

DIAGRAM REF.	CODE	DESCRIPTION	Q.TY
BOILER			
1	20114814	Power X 50 (A)	1
HYDRAULIC COMPONENTS and SAFETY DEVICES			
4	20028473	Hydraulic manifold for safety kit (B)	1
5	20028474	Safety kit (B)	1
-	20043895	Gas safety cut-off valve 200kW (B)	1

DIAGRAM REF.	CODE	DESCRIPTION	Q.TY
7	20028475	Hydraulic header separator for single applic.	1
FLUES / AIR INTAKE			
18	20028478	Air-intake kit B23 (C)	1
SUPPORTS FOR FREE-STANDING APPLICATION			
15	20046101	Power X rig	1
16	20047606	Rear mounting kit for free-standing applic. (D)	1

(A) Inside the Power X 50, it is possible to insert, in the proper compartment, the optional expansion vessel kit of 18 lt. (code 20119840) or the optional expansion vessel kit of 12 lt. (code 20119841).

(B) Optional safety component, according to I.N.A.I.L. Italian Safety Certification Institute (mandatory only on the Italian market).

(C) The Power X configurations can be completed with the flue options Ø80 mm of the section FLUES for CONDENSING BOILERS of the International Product Catalogue. As an alternative, you can use the concentric flue options Ø60/100 mm (by purchasing the flue adapter kit from Ø80-80 to Ø60/100, code 20028027) or the concentric flue options Ø80/125 mm (by purchasing the flue adapter kit from Ø80-80 to Ø80/125 code 20028029). In both cases, the accessory air-intake kit B23, code 20028478, is not necessary.

(D) In case you don't need a free-standing application, but you wish to anchor the Power X rig to the wall, you don't need to purchase the rear mounting kit for free-standing installation, code 20047606, (ref. 16).

FREE-STANDING APPLICATIONS

POWER X 50

CONFIGURATION FOR CENTRAL HEATING AND DHW TANK (WITH EXTERNAL 3-WAY VALVE)

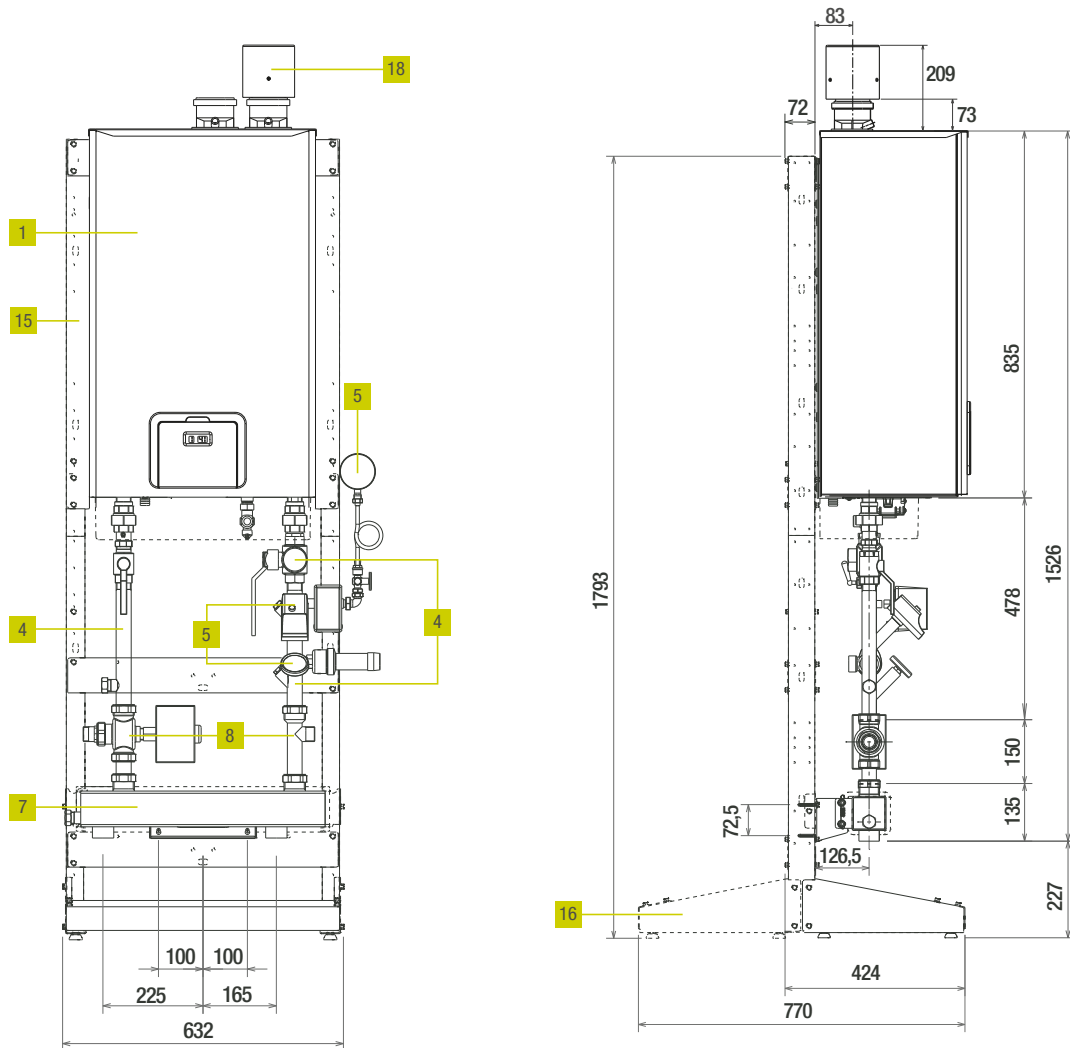

DIAGRAM REF.	CODE	DESCRIPTION	Q.TY
BOILER			
1	20114814	Power X 50 (A)	1
HYDRAULIC COMPONENTS and SAFETY DEVICES			
4	20028473	Hydraulic manifold for safety kit (B)	1
5	20028474	Safety kit (B)	1
-	20043895	Gas safety cut-off valve 200 kW (B)	1
7	20028475	Hydraulic header separator for single applic.	1

DIAGRAM REF.	CODE	DESCRIPTION	Q.TY
FLUES / AIR INTAKE			
18	20028478	Air-intake kit B23 (C)	1
ACCESSORIES FOR DHW TANK			
8	20028476	3-way valve kit for DHW tank	1
-	1103059	Well probe for DHW tank	1
SUPPORTS FOR FREE-STANDING APPLICATION			
15	20046101	Power X rig	1
16	20047606	Rear mounting kit for free-standing applic. (D)	1

- (A) Inside the Power X 50, it is possible to insert, in the proper compartment, the optional expansion vessel kit of 18 lt. (code 20119840) or the optional expansion vessel kit of 12 lt. (code 20119841).
- (B) Optional safety component, according to I.N.A.I.L. Italian Safety Certification Institute (mandatory only on the Italian market).
- (C) The Power X configurations can be completed with the flue options Ø80 mm of the section FLUES for CONDENSING BOILERS of the International Product Catalogue. As an alternative, you can use the concentric flue options Ø60/100 mm (by purchasing the flue adapter kit from Ø80-80 to Ø60/100, code 20028027) or the concentric flue options Ø80/125 mm (by purchasing the flue adapter kit from Ø80-80 to Ø80/125 code 20028029). In both cases, the accessory air-intake kit B23, code 20028478, is not necessary.
- (D) In case you don't need a free-standing application and you wish to anchor the Power X rig to the wall, you don't need to purchase the rear mounting kit, code 20047606 (ref. 16).



SCAN AND DISCOVER
Power X

Trading Address:
Via Risorgimento, 23/A
23900 LECCO (LC)
Italy
Tel. +39 0341 277111
Fax +39 0341 277263
info@berettaboilers.com
www.berettaboilers.com

In order to improve its products, Beretta reserves the right to modify the characteristics and information shown in this brochure at any time and without advance warning.
This brochure, therefore, cannot be considered as contractually binding on third parties.

 **Beretta**